

Please read carefully before operate the machine.



El Rocio TBG1–V15

## User guide

**HX Boiler**  
Stainless Steel



**PUMP Type**



**Dual Gauge**



**φ1,1 / 3 Hole**  
Steam Tip



**58mm**  
Group Head





**El Rocio**

**MANUS**  
espresso machine

- 1. Introduction**
- 2. Components**
- 3. Precautions before use**
- 4. User guide**
- 5. Cleaning & Maintenance**
- 6. Alert indicator & Frequent questions**

## Components

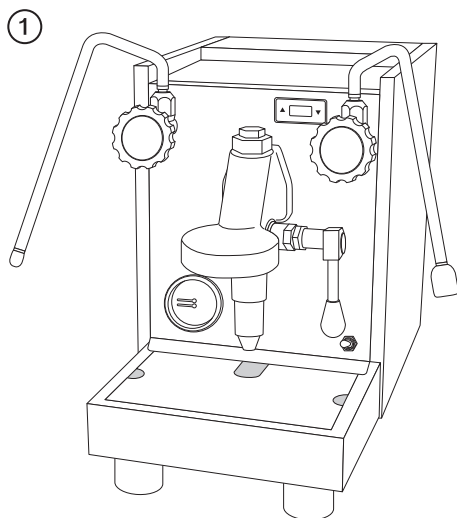

- ① Manus
- ② 2 spout porta filter
- ③ Blind rubber pad
- ④ Cleaning brush
- ⑤ 7g basket
- ⑥ 14g basket
- ⑦ User guide

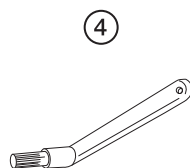
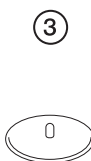
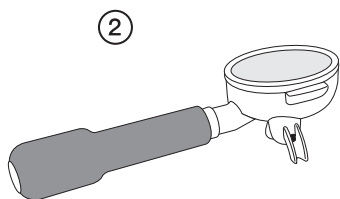

## Components

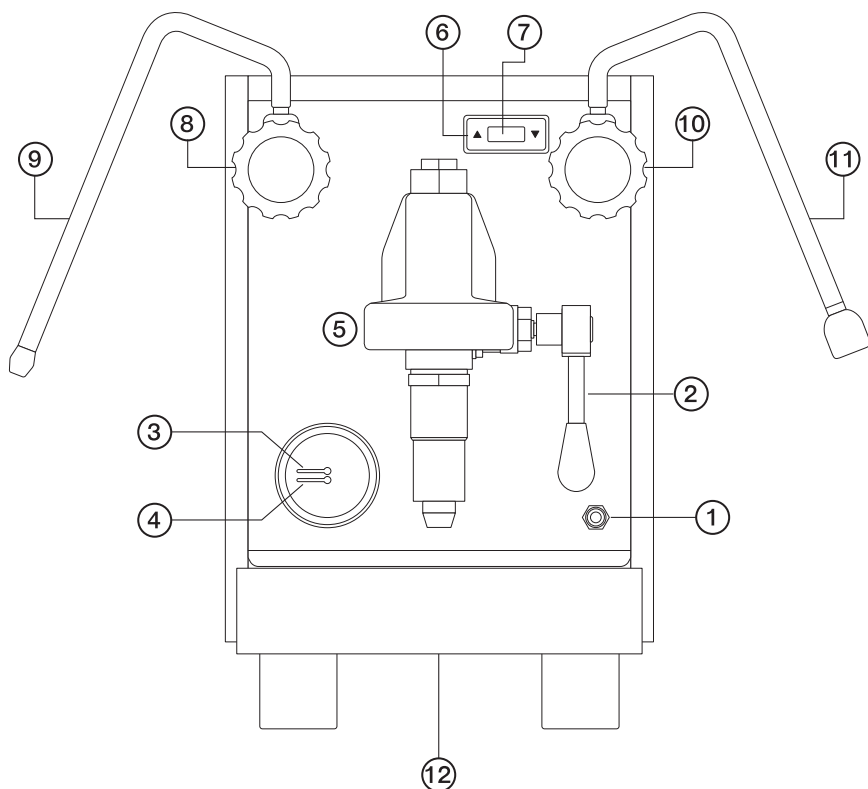

- |                            |                         |
|----------------------------|-------------------------|
| ① Power switch             | ⑦ Steam temp. indicator |
| ② Extraction lever         | ⑧ Steam knob            |
| ③ Steam pressure gauge     | ⑨ Steam wand            |
| ④ Extration pressure gauge | ⑩ Hot water knob        |
| ⑤ E-61 Grouphead           | ⑪ Hot water wand        |
| ⑥ PID controller           | ⑫ Drain tray            |

## Components

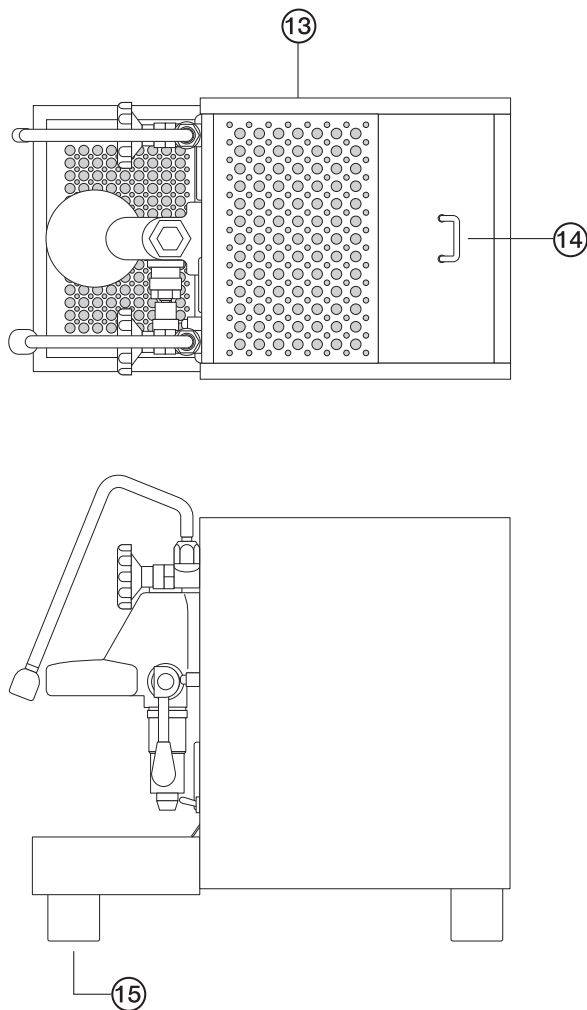

- ⑬ Cup warmer
- ⑭ Water tank cover
- ⑮ Adjustable foot

## Precautions before use

- ※Users must read the precautions as following.  
If users do not observe following instruction,  
El Rocio Will not take any responsibilities for any accidents.



Caution

This product made for 220V / 60Hz and 1.5Kw usage.  
Please use the right voltage.  
If you do not follow our instruction, the manufacturer  
may not be held liable for any injuries.

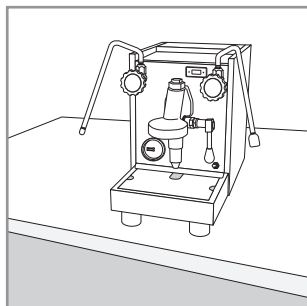

Caution

(Heavy product)  
Product weight 22kg

- Install the product by maintaining a correct posture.
- Install the product on solid and flatted surface.



caution for burn

Before move the machine, please empty out the water from  
the water bucket and cool down the hot water and steam boiler.

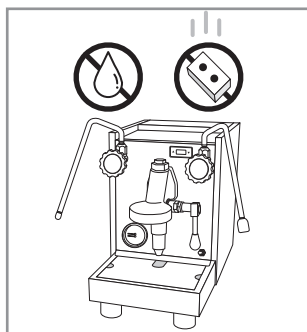

- Do not place any liquids including water and milk on the cup warmer.
- Do not cover any cloths while operating the machine.
- Place the machine away from children.

## Precautions before use

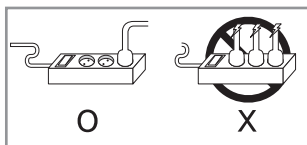

- Please connect the machine to the certified multi-tab.  
This product has to use over 10A(1.5Kw).
- ※ Do not use several plugs on a multi-tab, it might caused for fire accidents.

- Please keep away the power connector from sharp objects and liquid (inflammable&combustible).

- Keep space out from heat sources or electrical products.

- Please do not touch this machine by wet hands, it might caused for electric shock accidents.

- Please do not pull or squash the power cord. (no random changes for the cord)

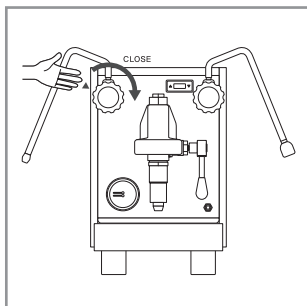

- Please close the steam and hot water valves to clockwise before turns on the machine.
- ※ However, open the hot water valve to counter clockwise to release the hot water boiler's water only for the first operation.

- Steam and hot water wands are cool touched, however it might caused for burning accident by long time using.

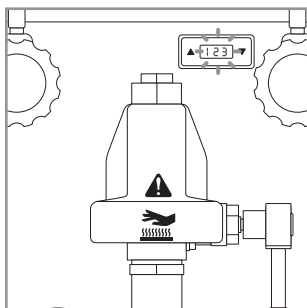

- Please do not touch the grouphead while operating the machine, it might caused for burning accidents.



## Alert indicator

You can check the machine's condition after the machine's power is on.



### • Temperature indication

check

Indicates the current temperature.  
You can adjust the steam temperature.

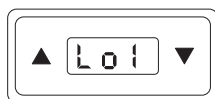

### • No water in water bucket

check

Please fill the water to water bucket.  
Please take out the water bucket before fill the water.

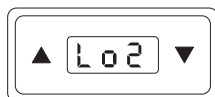

### • No water in the boiler

check

Please fill the water to water bucket before turn on the machin  
it will fill the water to boiler from water bucket.

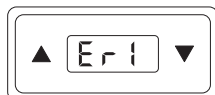

### • PID Error

check

Turn off the machine and cool down. Then turn on the machine.  
If it does not work after above steps, please contact our techn  
support or purchasing office.



## User guide

**We recommend you to extract espresso at least 30 seconds and after an extraction, please be on standby for 1minute.**

### 1. Water bucket separation from the machine and fill the water.(Vibration model only)

· Please separate water bucket from the machine before power the machine on as following steps.

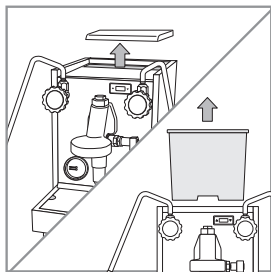

1) Open the water bucket cover and pull out the water bucket.

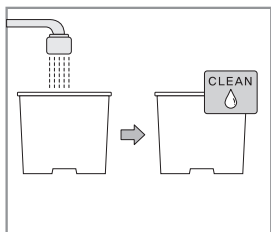

2) After clean the water bucket, please dry the water bucket's surface.

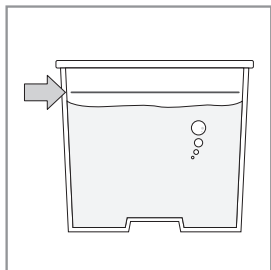

3) Please fill the water until the guide line after cleaning.



Caution

When you separate or fill the water to water bucket, please turn off the machine first.

## User guide

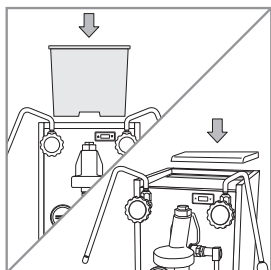

4) Hold the water bucket by both of your hands and put it back.

check

Please check inside of the water bucket if there are any foreign substance.

## 2. Turn on the machine and preheating

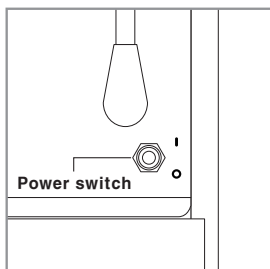

- 1) Please read the precaution for the machine and before plug-in.
- 2) Turn on the main power.
- 3) For first operation, operation pump will operate to fill the water in the boiler.
- 4) Please preheat until the temperature indicator reaches to your set temperature.  
(For steam, if the gauge indicates 1~1.5 bar, it is ready to use.)

check

Please read the precaution carefully and check steam and hot water knobs before power the machine on.

## User guide

**Rotary model can connect the water directly only.  
Please use the right connect adaptor for water supply hose.**

### 3. Connect water(rotary model only)

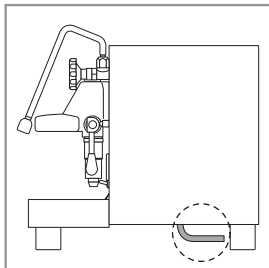

1) Check the water supply hose from the bottom of machine.

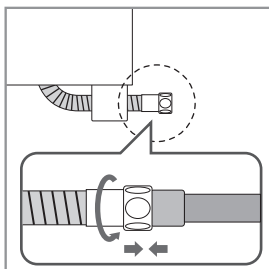

2) Please check the water connection type and connect the water connect hose.

check

Please use the right sized connect adopter to connect to water purifier.

## User guide

### 4. Extraction

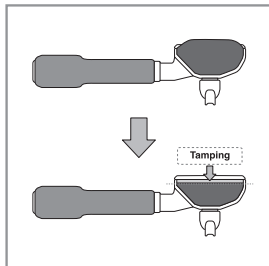

- 1) Put ground coffee bean in porta filter and tamp it.

check

When you tamp the ground coffee bean, be careful for your wrist.

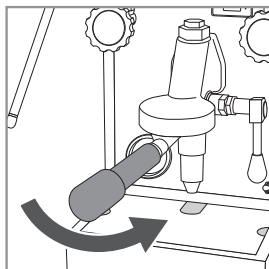

- 2) Install the porta filter from 7 O'clock direction to clockwise.

Make sure the portafilter's wings are completely inserted to grouphead. Before install the porta filter, we suggest you to press extraction lever for 1~2 seconds to get rid of any foreign substances and heat up the grouphead.

check



Caution

Do not touch the grouphead by any part of your body. It might caused for burning accidents.  
•The grouphead and hot water temperature are 85~99 Celsius degree

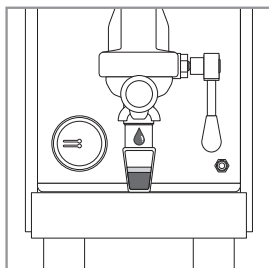

- 3) Lift the extraction lever to extract espresso as much you want.

check

Do not use hot water until extracting. Do not take off portafilter while extracting, it might caused for burning and explode accidents.

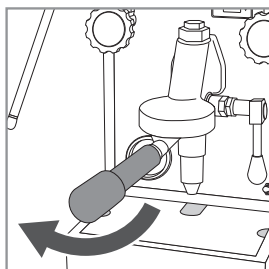

- 4) After extraction, turn the handle of portafilter to clockwise to take off the the porta filter.

## User guide

## 5. Use steam

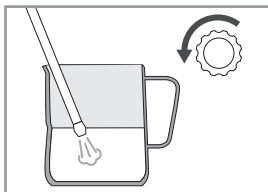

- 1) Put the steam wand in filled the pitcher by milk and turn the steam knob to counter clockwise.

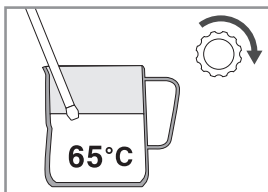

- 2) Once the milk reached to certain temperature, turn the steam knob to clockwise to off.

check



Caution

Do not touch directly by any part of your body, it might caused for burning accidents.  
When you take out the condensated water from the steam wand, nozzle should face to drain basket and use wet cloth.

## 4. Use hot water

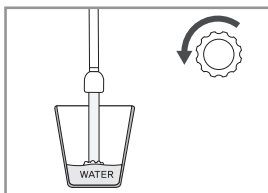

- 1) Turn the hot water knob to counter clockwise to get hot water.

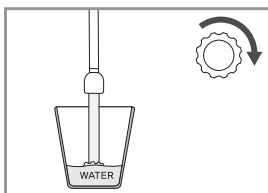

- 2) After receive the hot water enough, turn the hot water knob to clockwise to close.

check



Caution

Steam and hot water wands are cool touched, however it might caused for burning accident by long time using.

## Cleaning and maintenance

- ※ **Must turn off and cooled down the machine completely, then start cleaning.**

### 1. Grouphead cleaning

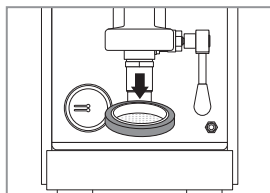

- 1) Take off the shower screen as picture instruction.

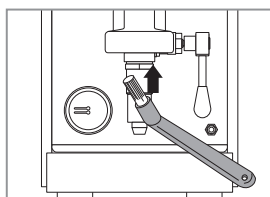

- 2) Clean inside of the grouphead by cleaning brush.

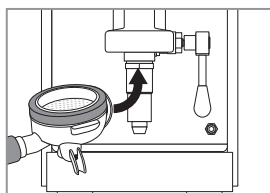

- 3) After cleaning, use a porta filter to install the shower screen.



Caution

check

Do not take off the shower screen by hand.

### 2. Steam / Hot water wands cleaning

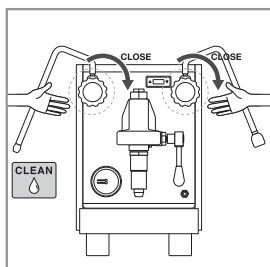

- 1) Grab the rubber grips to fasten clean steam / hot water wands.



Caution

check

Steam / Hot water knobs must closed before cleaning.

## Cleaning and maintenance

### 3. Water bucket cleaning (Vibration model only)

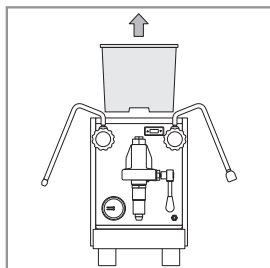

1) Take off the water bucket.

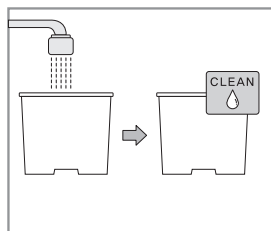

2) Clean the water bucket.

3) Dry the water bucket and install back in.

### 4. Drain tray cleaning

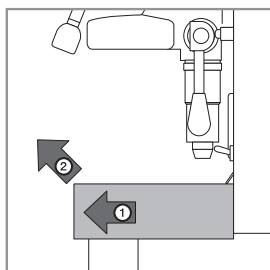

1) Pull the drain tray out nicely by both hands.

2) Clean the drain tray and put it back on.

check

Do not use excessive force to pull the drain tray, it might caused to spatter things from the drain tray.

## Frequent questions

**Q. It is not indicating the temperature on indicator and just indicating Lo1.**

**A. Please fill the water to water bucket.**

**Q. The machine makes noise when the machine turns on first time.**

**A. Please check the water bucket if there is water enough,  
it is filling water to boiler by pump.**

**Q. Water leaks from the porta filter while extracting.**

**A. Please check the volume of ground coffee in the porta filter  
and install the porta filter to grouphead until it doesn't turn more.**

check

**All the heating elements installed more than 3 types of safety devices.  
Please replace consumable parts as following list.**

**※ Consumable parts: Gasket, screen, basket, block spring,  
hot water & steam nozzle rubber rings)**



MEMO

MEMO

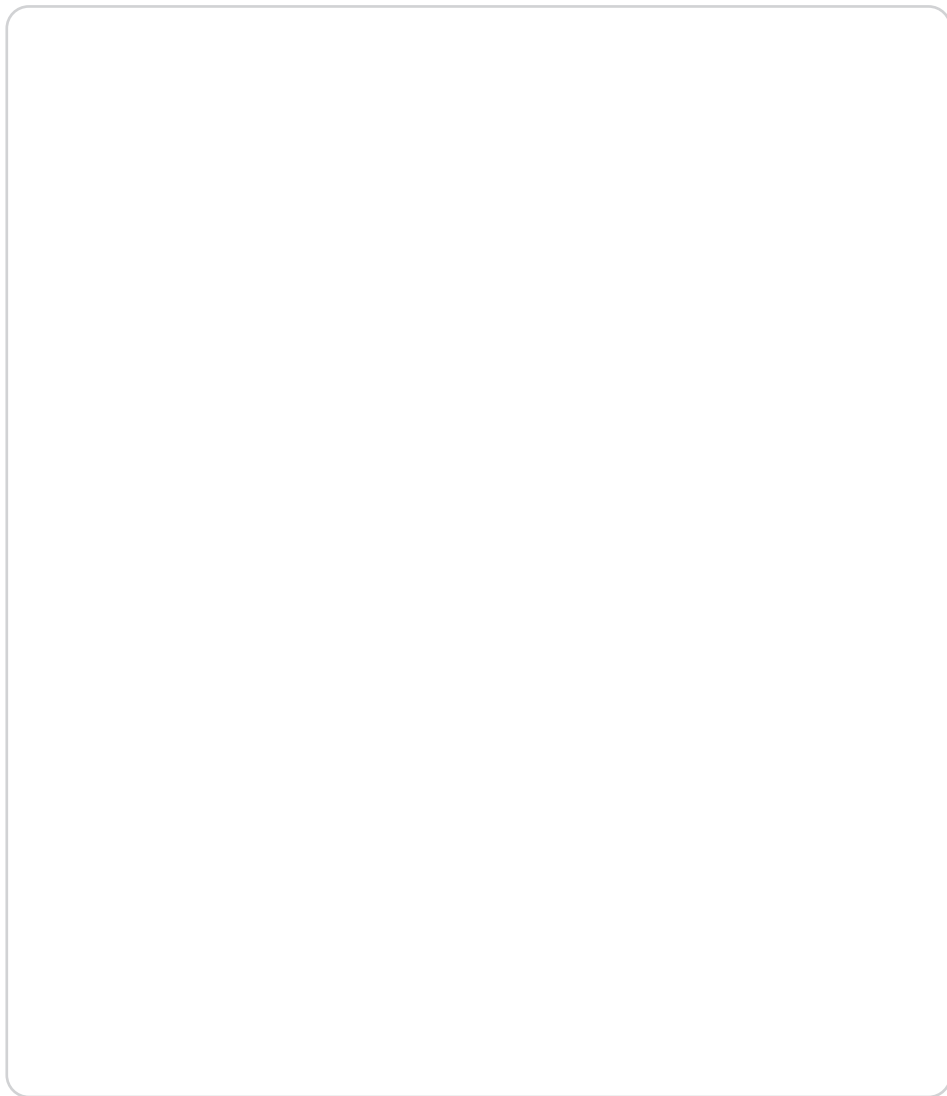

MEMO

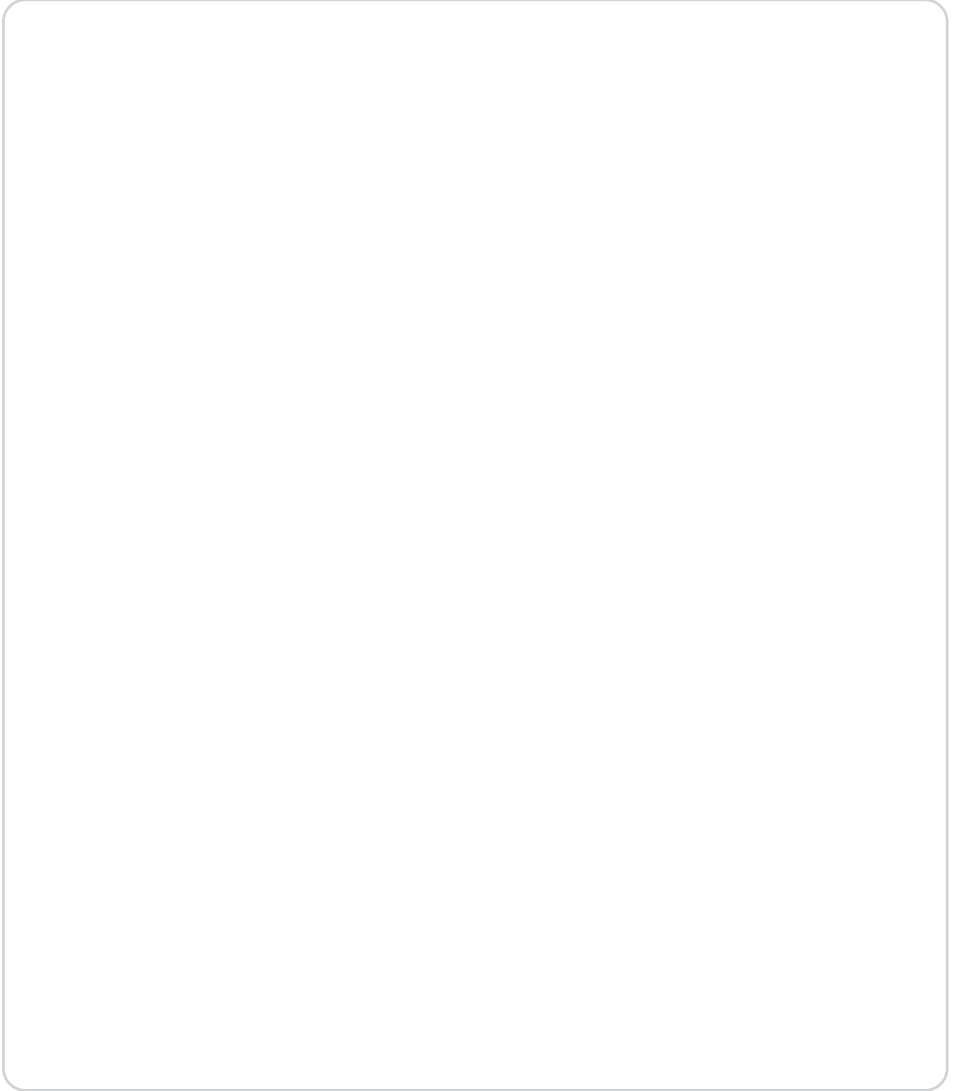
A large, empty rectangular box with rounded corners, intended for a memo or note. The box is light gray and occupies most of the page below the 'MEMO' label.

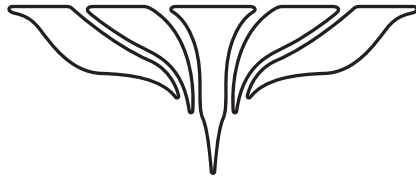

**El Rocio**

Dual Boiler Espresso Coffee Machine

[www.elrocio.co.kr](http://www.elrocio.co.kr)